



Ergotron® 100 Series

for low profile systems

Highlights

- *Patented Suspension Technology allows monitors to swing, tilt or rotate*
- *Slim profile saves space*
- *Provides smooth adjustment while maintaining touch-screen stability without the need for knobs or levers*
- *Up to 180° of forward/back LCD tilt and 180° of side-to-side LCD pan*
- *Internal steel construction for long-lasting durability and easy to clean plastic exterior*
- *Weight capacity up to 25 lbs (11.3 kg)*
- *Multiple keyboard tray options provide optimum ergonomic comfort*
- *Fold up keyboard against the wall when not in use*
- *Attaches to LCDs that are VESA® MIS-D, 100/75, C compliant*
- *5 year warranty*



The 100 Series allows flat panel monitors, keyboards and laptops to be mounted with a minimum profile while providing side-to-side and forward-back pivot movement. The patented friction system provides smooth adjustment while maintaining touch-screen stability.

Choose from Single Pivot with Portrait/Landscape (P/L), Double Pivot with P/L and Keyboard/Laptop Pivots to suit your application. Multiple surface attachment and accessory options are available.



Pivot shown mounted to Wall Track. Wall Track can provide a common interface for multiple Pivots.

All 100 Series can be mounted directly to surfaces with appropriate fasteners (Double Pivot with P/L shown).

Single Pivot with P/L shown mounted to Wall Plate.

Keyboard Pivot shown with Keyboard Tray—folds up flat when not in use (see inset photo).

100 Series shown mounted to 2" round pole.



General Dimensions

Single Pivot with P/L

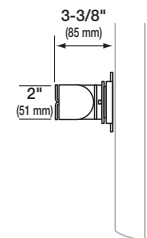

Double Pivot with P/L

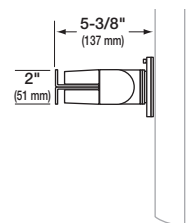

Keyboard/Laptop Pivot

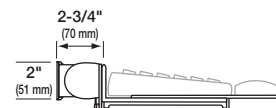

Range of Motion

Note: Actual range of motion depends on mounting surface and size of monitor.

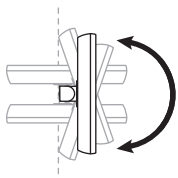

LCD tilts up to 180° forward/back

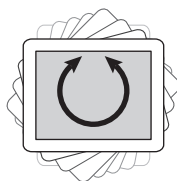

LCD rotates up to 360° portrait/landscape

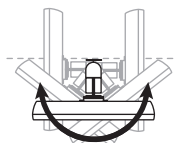

LCD pans up to 180° right/left

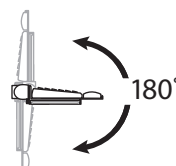

Keyboard tilts up to 180° forward/back

Basic Specifications

Application Options: Direct to Surface, Wall Track, Wall Plates, Poles, Slatwall, Office Panels, Command Post, Mobile WorkStands

Display Interface Options:

- VESA FDMI MIS-D, 100/75, C (hole pattern: 100 x 100 mm & 75 x 75 mm)

Colors: Available in black and grey*

* Black and grey plastic covers are included with each product.

Weight Capacity

- Single Pivot w/ P/L: 25 lbs (11.3 kg)
- Double Pivot w/ P/L: 23 lbs (10.4 kg)
- Keyboard/Laptop Pivot: 7.5 lbs (3.4 kg)

Accessory Options: Extenders, Quick Release Kit, Tamper Resistant Kit, Keyboard Trays, Laptop Trays, Wrist Rests, Mouse Pads, Mouse Pouches, CPU Holders, Surge Suppressors and Power Strips

© 2005 Ergotron, Inc.
rev. 08/25/2006 870-05-026

Content is subject to change
without notification.

Ergotron, Inc.: St. Paul, MN; (800) 888-8458;
www.ergotron.com; sales@ergotron.com

Ergotron Europe: Amersfoort, The Netherlands;
Tel. +31 33 45 45 600; info.eu@ergotron.com

Ergotron Asia: (800) 468-3917 ext. 7617;
info.apac@ergotron.com

